

IT-36CI



## FEATURES

- Dual refrigeration keeps food fresher longer
- Air purification system fights spoilage, odors
- Water-filtration system for ice reduces contaminants, chlorine taste and odor
- Automatic ice maker with "max ice" feature
- Over-and-under refrigerator/freezer storage
- Ready to be fitted with custom panels and handles to blend with cabinetry
- Rigorously tested in our U.S. manufacturing facilities to ensure decades of use
- Exceptional 24/7 support from Madison, WI-based Customer Care team

## ACCESSORIES

- Air Purification Cartridge
- Egg Container
- Stainless steel tubular handles
- Stainless steel pro handles
- Dual installation kits
- Stainless steel front panels with tubular or pro handles
- Stainless steel kickplate
- Stainless steel side enclosure
- Stainless steel top enclosure
- Reduced toe kick divider for toe kicks from 2" to 3.875"
- Replacement water filter

Accessories are available through an authorized Sub-Zero dealer.  
For local dealer information, visit [subzero-wolf.com/locator](http://subzero-wolf.com/locator).



## HANDLE ACCESSORIES

PRO



TUBULAR



## PRODUCT DETAILS

### REFRIGERATOR

- Three adjustable glass shelves
- One stationary shelf
- Crisper drawer with two adjustable dividers
- Adjustable dairy compartment
- Two adjustable door shelves
- One stationary door shelf

### FREEZER

- Three adjustable drawer dividers
- Removable ice container
- Automatic ice maker

## PRODUCT SPECIFICATIONS

Model	IT-36CI
Dimensions	36"W x 84"H x 24"D
Door Clearance	34 1/2"
Drawer Clearance	18 3/8"
Weight	460 lb
Refrigerator Capacity	13.3 cu ft
Freezer Capacity	6.4 cu ft
Electrical Supply	115 VAC, 60 Hz
Electrical Service	15 amp dedicated circuit
Plumbing Supply	1/4" OD copper, braided stainless steel or PEX tubing
Plumbing Pressure	35–120 psi
Receptacle	3-prong grounding-type

## ELECTRICAL

## PLUMBING

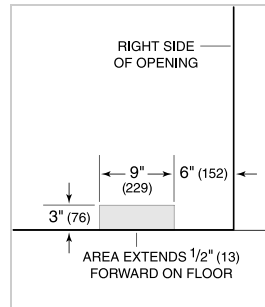
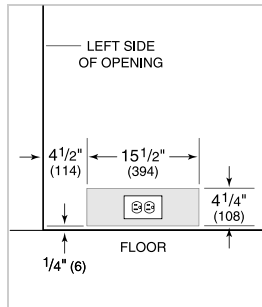

## INTERIOR VIEW

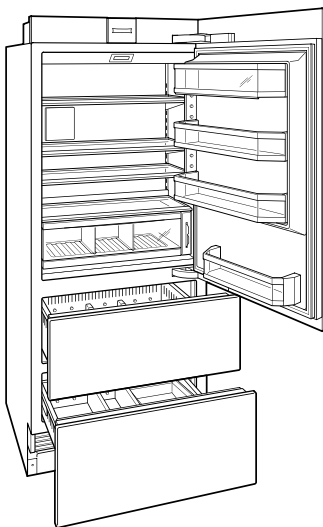

This illustration is intended for interior reference only and may not represent the exterior of the model being specified.

## DIMENSIONS

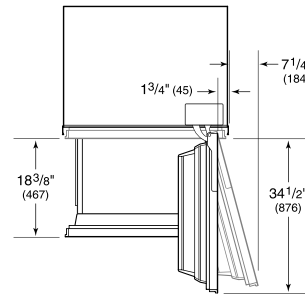
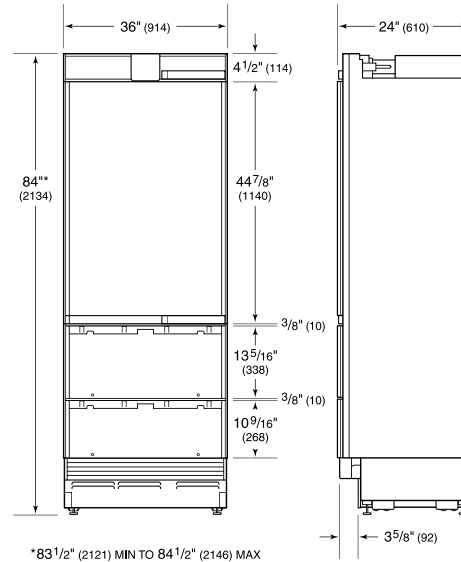

## STANDARD INSTALLATION

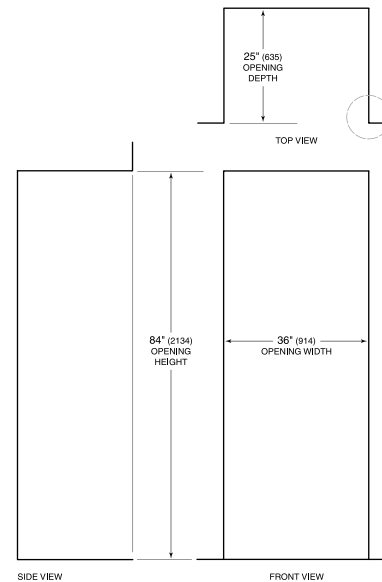

NOTE: 3/16" (89) finished returns will be visible and should be finished to match cabinetry.

